

The **PROJOLLY** line in polished aluminium offer innumerable opportunities of combining them with ceramics, wood, marble, etc. It facilitates the laying process eliminating the fragile ceramic corner tiles. It is also used for external angles of tiles, in order to terminate the finishing of wall coverings, for platforms, stair steps, bathtubs, etc. It guarantees the impeccable work, ensuring considerable aesthetic effect as well. Thanks to its round finishing it strengthens the tile edge and prevents from their chipping and breakages. Required by new European regulations on safety and accident prevention in public and private places. Available in capsules and three-axial joints for internal and external angles. Chromatic combining with **PROLISTEL** and **PROLISTEL** panelists in polished aluminium recommended.



POLISHED ALUMINIUM (chrome-copper-titanium-gold-black) **thermo cap**
bar length 2,7 LM - packaging 40 Pcs - 108 LM (H 15 mm - 54 LM)

Article	H mm		
PJBC 06 (polished chrome)	6		
PJBO 06 (polished gold)	6		
PJBR 08 (polished copper)	8		
PJBT 08 (polished titanium)	8		
PJBO 08 (polished gold)	8		
PJBC 08 (polished chrome)	8		
PJBN 08 (polished black)	8		
PJBR 10 (polished copper)	10		
PJBT 10 (polished titanium)	10		
PJBO 10 (polished gold)	10		
PJBC 10 (polished chrome)	10		
PJBN 10 (polished black)	10		
PJBR 125 (polished copper)	12,5		
PJBT 125 (polished titanium)	12,5		
PJBO 125 (polished gold)	12,5		
PJBC 125 (polished chrome)	12,5		
PJBN 125 (polished black)	12,5		
PJBC 15 (polished chrome)	15		

EXAMPLES AND INSTRUCTIONS FOR LAYING METHODS

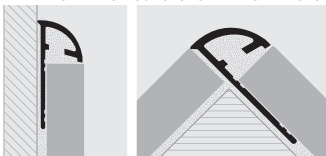

1. Choose the PROJOLLY with suitable height for the thickness of the covering. 2. Apply the adhesive onto the area of application of the profile. 3. Lay and align the profile, cut to the necessary length, pressing the perforated flange into the adhesive. 4. Lay the tiles, aligning them so that the top edge of the profile is flush with the tile. 5. Fill the profile/tile area of contact with adhesive to prevent the accumulation of water in any voids. **IMPORTANT:** Pay attention to the external edges of the aluminium Projolly. They must be protected against agents such as adhesives and sealants and against grinding or scraping actions.

COLOURS

(for a precise assessment of colours and finishes, see the relative enclosed sheet)



CAPSULES, END CAPS and JOINTS for tri-axial joints

POLISHED ALUMINIUM (chrome, copper, titanium, gold, black) / PLASTIC

END CAPS - POLI. ALUMINIUM chrome, copper, titanium, gold, black

Article	H mm	10 pcs	2 pcs
TPJ... 06-08-10-125-15/... 6-8-10-125-15			

JOINTS - PLASTIC

Article	H mm	10 pcs	2 pcs
GIJA 06-08-10-125-15/... 6-8-10-125-15			

Choose the desired packaging: E.g. GIJA .../10 (pack 10 pcs)
GIJA .../2 (pack 2 pcs)

END CAP

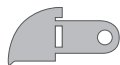

TPJ... 06-08-10-125-15/...

JOINT



GIJA 06-08-10-125-15/...

OUTSIDE CAPSULES



CPJ...
06-08-10-125-15/...



CPJD...
06-08-10-125-15/...

INSIDE CAPSULES



IPJ...
06-08-10-125-15/...



IPJD...
06-08-10-125-15/...

LEFT CAPSULES POLISHED ALUMINIUM chrome, copper, titanium and gold

Article	H mm	10 pcs	2 pcs
CPJBC/BO 06/... (outside)	6		
IPJBC/BO 06/... (inside)	6		
CPJBC/BO 08/... (outside)	8		
IPJBC/BO 08/... (inside)	8		
CPJBR 08/... (outside)	8		
IPJBR 08/... (inside)	8		
CPJBT 08/... (outside)	8		
IPJBT 08/... (inside)	8		
CPJBC/BO 10/... (outside)	10		
IPJBC/BO 10/... (inside)	10		
CPJBR 10/... (outside)	10		
IPJBR 10/... (inside)	10		
CPJBT 10/... (outside)	10		
IPJBT 10/... (inside)	10		
CPJBC/BO 125/... (outside)	12,5		
IPJBC/BO 125/... (inside)	12,5		
CPJBR 125/... (outside)	12,5		
IPJBR 125/... (inside)	12,5		
CPJBT 125/... (outside)	12,5		
IPJBT 125/... (inside)	12,5		
CPJBC 15/... (outside)	15		
IPJBC 15/... (inside)	15		

Choose the desired packaging: E.g. CPJBC .../10 (pack 10 pcs)
CPJBC .../2 (pack 2 pcs)

LEFT CAPSULES POLISHED ALUMINIUM black

Article	H mm	10 pcs	2 pcs
CPJBN 08/...	8		
IPJBN 08/...	8		
CPJBN 10/...	10		
IPJBN 10/...	10		
CPJBN 125/...	12,5		
IPJBN 125/...	12,5		

The right capsules are available on demand and must be used only in the following cases:

A) when you are laying the cut base of the profile perpendicularly on the floor;



Add "D" to the article code. For example: CPJDBC 06.

B) as an alternative to end-caps (right side).

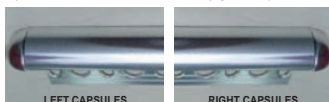

Add "D" to the article code. For example: CPJDBC 06.

* = Upon request, price and delivery time to be agreed.